

GREYSTONE

*Exclusive Brokers
for Suburban Station*

Suburban Station Retail Opportunity



PROPERTY DETAILS

The available space is located within the main concourse of Suburban Station, with prominent visibility. The space includes an area of approximately 380 SF. The space includes multiple refrigeration units, an icemaker, and food preparation area.

We welcome creative uses for this space including food service, and coffee/beverage.

SEPTA's Suburban Station is centrally located in Center City Philadelphia, and serves as a vital link between various transit modes including regional rail, subway, and bus services. The station's centrality captures both commuter and office worker traffic.

Size: 380 SF

Daily Ridership: ±13,000

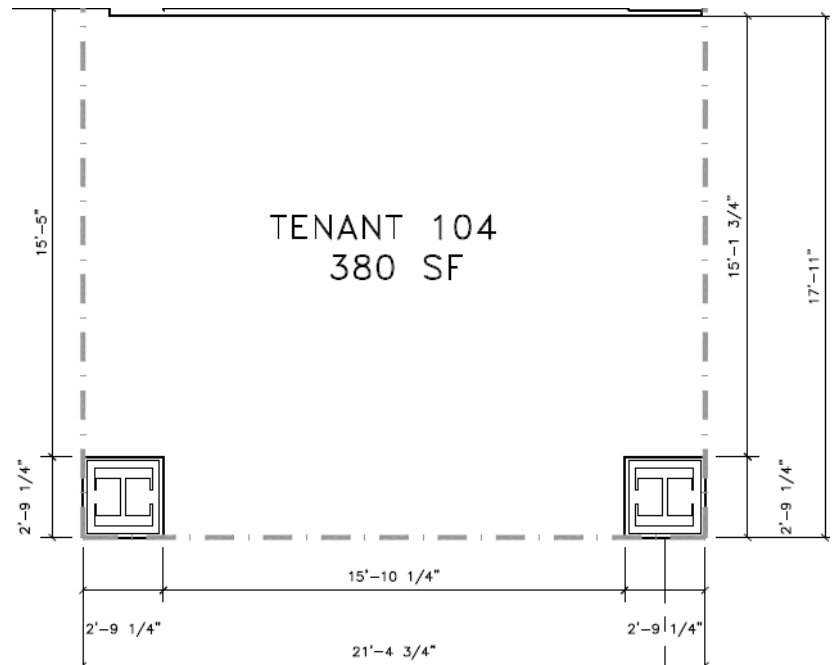

For more information please contact:

Greystone Brokerage Services LLC

Charles Di Maggio | (215) 918-8892

SEPTALeasing@greystone.com

AVAILABLE FOR LEASE

± 380 SF | RETAIL SPACE

UNIT #1623

